

We are.



We are a community of Subaru owners connected by our passions.

What's Your Story?

Share it! #badgeofownership

See reverse side for installation instructions.

Subaru Badge of Ownership

Installation Instructions Read all instructions before starting installation process.



To add Lifestyle Icons to an existing Badge of Ownership, skip to Step 2.

1. Determine optimum location for the Badge of Ownership on the back of your vehicle. For example, underneath the Subaru logo on the surface of the trunk lid or rear hatch.
2. Clean surface with a 50:50 mixture of isopropyl alcohol and water.
3. Place template (below) to be parallel to the body line of the car. Use masking tape to adhere the template to the surface. [See Illustration A.](#)
4. Do a trial run before adhering the Loyalty Number/Lifestyle Icon to the vehicle surface by aligning one along the template.
5. The Lifestyle Icons have a left-sided tab that inserts into the Loyalty Number's right-sided slot. [See Illustration B.](#)
6. Peel tape liner from the back of the Loyalty Number/Lifestyle Icon. Caution: Once the tape from the back of the Badge of Ownership comes in contact with the vehicle it cannot be moved.
7. Carefully align the Loyalty Number/Lifestyle Icon along the template. [See Illustration C.](#)
8. Press down onto the vehicle surface and hold for 30 seconds. Optimum strength is achieved 24 hours after application.
9. Remove template. Your Badge of Ownership installation is now complete. [See Illustration D.](#)

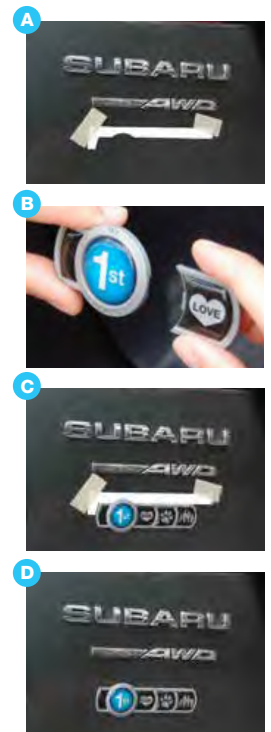

Warnings

Do not wash car for a 24 hour period after applying your Badge of Ownership.
Ideal temperature is 70 – 90°F for installation.

 **Cut along lines to create template.**

